

# Licensing Act 2003 Premises Licence

# PL0337

## LOCAL AUTHORITY

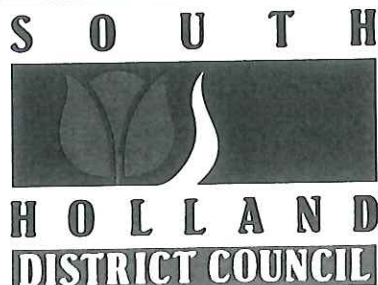

### South Holland District Council

Licensing Dept  
Council Offices  
Priory Road  
Spalding  
Lincolnshire  
PE11 2XE

tel: 01775 761161  
web: www.sholland.gov.uk

## Part 1 - Premises Details

### POSTAL ADDRESS OF PREMISES, OR IF NONE, ORDNANCE SURVEY MAP REFERENCE OR DESCRIPTION

#### Delicja

Unit2, 20 Westlode Street, Spalding, Lincolnshire, PE11 2AF.

### WHERE THE LICENCE IS TIME LIMITED THE DATES

Not applicable

### LICENSABLE ACTIVITIES AUTHORISED BY THE LICENCE

- the supply of alcohol

### THE TIMES THE LICENCE AUTHORISES THE CARRYING OUT OF LICENSABLE ACTIVITIES

Activity (and Area if applicable)	Description	Time From	Time To
Supply of alcohol for consumption	OFF the premises only Monday to Sunday	7:00am	9:00pm

### THE OPENING HOURS OF THE PREMISES

Description	Time From	Time To
Monday to Sunday	7:00am	9:00pm

### WHERE THE LICENCE AUTHORISES SUPPLIES OF ALCOHOL WHETHER THESE ARE ON AND / OR OFF SUPPLIES

Supply of alcohol for consumption OFF the premises only

## Part 2

### NAME, (REGISTERED) ADDRESS, TELEPHONE NUMBER AND EMAIL (WHERE RELEVANT) OF HOLDER OF PREMISES LICENCE

Mohammad Salih Attuf

### REGISTERED NUMBER OF HOLDER, FOR EXAMPLE COMPANY NUMBER, CHARITY NUMBER (WHERE APPLICABLE)

### NAME, ADDRESS AND TELEPHONE NUMBER OF DESIGNATED PREMISES SUPERVISOR WHERE THE PREMISES LICENCE AUTHORISES THE SUPPLY OF ALCOHOL

Dairy Sleman JALAL



Licensing Act 2003

PL0337

# Premises Licence

PERSONAL LICENCE NUMBER AND ISSUING AUTHORITY OF PERSONAL LICENCE HELD BY DESIGNATED PREMISES SUPERVISOR WHERE THE PREMISES LICENCE AUTHORISES FOR THE SUPPLY OF ALCOHOL

Licence No. PA0975

Issued by South Holland



# Premises Licence

## ANNEXES

## Annex 1 - Mandatory Conditions

1. No supply of alcohol may be made under the premises licence at a time when there is no designated premises supervisor in respect of the premises licence.
2. No supply of alcohol may be made under the premises licence at a time when the designated premises supervisor does not hold a personal licence or his personal licence is suspended.
3. Every supply of alcohol under the premises licence must be made or authorised by a person who holds a personal licence.
4.
  - (1) The premises licence holder or club premises certificate holder must ensure that an age verification policy is adopted in respect of the premises in relation to the sale or supply of alcohol.
  - (2) The designated premises supervisor in relation to the premises licence must ensure that the supply of alcohol at the premises is carried on in accordance with the age verification policy.
  - (3) The policy must require individuals who appear to the responsible person to be under 18 years of age (or such older age as may be specified in the policy) to produce on request, before being served alcohol, identification bearing their photograph, date of birth and either-
    - (a) a holographic mark, or
    - (b) an ultraviolet feature.
5. A relevant person shall ensure that no alcohol is sold or supplied for consumption on or off the premises for a price which is less than the permitted price.
6. In this condition:
  - (a) "permitted price" is the price found by applying the formula  $P = D + (D \times V)$ , where:
    - (i) P is the permitted price
    - (ii) D is the amount of duty chargeable in relation to the alcohol as if the duty were charged on the date of the sale or supply of the alcohol, and
    - (iii) V is the rate of value added tax chargeable in relation to the alcohol as if the value added tax were charged on the date of the sale or supply of the alcohol
  - (b) "duty" is to be construed in accordance with the Alcoholic Liquor Duties Act 1979
  - (c) "relevant person" means, in relation to premises in respect of which there is in force a premises licence:
    - (i) the holder of the Premises Licence
    - (ii) the Designated Premises supervisor (if any) in respect of such a licence, or
    - (iii) the Personal Licence Holder who makes or authorises a supply of alcohol under such a licence
  - (d) "relevant person" means, in relation to premises in respect of which there is in force a Club Premises Certificate, any member or officer of the club present on the premises in a capacity which enables the member or officer to prevent the supply in question; and
  - (e) "value added tax" means value added tax charged in accordance with the Value Added Tax Act 1994.



# Premises Licence

ANNEXES continued ...

7. Where the permitted price would not be a whole number of pennies, the permitted price shall be taken to be the price rounded up to the nearest penny.
8. Where the permitted price on a day ("the first day") would be different from the permitted price on the next day ("the second day") as a result of a change to the rate of duty or value added tax, the permitted price which would apply on the first day applies to sales or supplies of alcohol which take place before the expiry of the period of 14 days beginning on the second day.



# Premises Licence

ANNEXES continued ...

## Annex 2 - Conditions consistent with the operating schedule

### Prevention of Crime & Disorder

1. CCTV system will be registered in accordance with the Data Protection Act and relevant codes of practice.
2. There shall be sufficient cameras to cover those areas that are not easily supervised from the counter with one of the cameras providing a front facial view of customers at the tills.
3. The system will be capable of continuously recording and copies of such recordings shall be kept for a period of not less than 28 days and handed to a Police Constable or authorised person upon request.
4. If the system uses tapes then there should be sufficient for 28 days. These tapes will need to be replaced every six months to maintain the quality of the images recorded.
5. The premises licence holder will be responsible for the operation of the system and shall ensure that it is maintained in accordance with these codes of practice.
6. The system shall be maintained in working order.
7. Recordings will be made of each trading period conducted at the premises.

### Public Safety

None

### Prevention of Public Nuisance

None

### Protection of Children from Harm

1. Compliance will be made with the Premises Age Verification Policy.
2. The Challenge 21 Initiative to be adopted. There shall be in place for the premises a written policy to prevent the sale or supply of alcohol to persons under 18 years of age. That policy shall require any person who appears to be under the age of 21 years to produce a form of identification, which is compliant with the following:
  - a. The card has a verifiable means of accreditation for the information held upon it. (ie. Issued by Central or Local Government, recommended by Home Office or ACPO, supported by Government eg. Photo Driving Licence, Passport, PASS card)
  - b. The information on the card provides the date of birth of the holder
  - c. The card provides information to identify the holder both by name and photograph
  - d. The card can be authenticated beyond reasonable doubt to avoid acceptance of fake/fraudulent identification.
3. Appropriate signage will be displayed in the premises, particularly at the point of sale and at the checkout.



# Premises Licence

ANNEXES continued ...

4. Refusal book to be kept on the premises to be completed on refusal and audited from time to time by the DPS as part of staff training.
5. The Premise Licence Holder will ensure that staff are made aware of the existence and content of this Policy and will ensure that the staff receive regular training sufficient and appropriate to the implementation and operation of this policy.

**Annex 3 - Conditions attached after a hearing by the licensing authority**



# Premises Licence

ANNEXES continued ...

## Annex 4 - Plans

See attached

Signed by:



on behalf of South Holland Council



## Premises Licence Summary

## LOCAL AUTHORITY

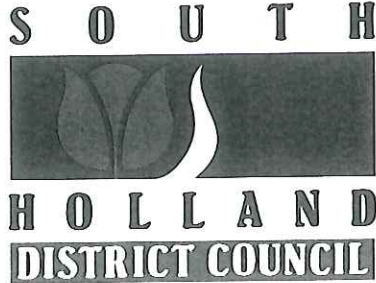

## South Holland District Council

Licensing Dept  
Council Offices  
Priory Road  
Spalding  
Lincolnshire  
PE11 2XE

tel: 01775 761161

web: www.sholland.gov.uk

## Premises Details

## POSTAL ADDRESS OF PREMISES, OR IF NONE, ORDNANCE SURVEY MAP REFERENCE OR DESCRIPTION

**Delicja**

Unit2, 20 Westlode Street, Spalding, Lincolnshire, PE11 2AF.

## WHERE THE LICENCE IS TIME LIMITED THE DATES

Not applicable

## LICENSABLE ACTIVITIES AUTHORISED BY THE LICENCE

- the supply of alcohol

## THE TIMES THE LICENCE AUTHORISES THE CARRYING OUT OF LICENSABLE ACTIVITIES

Activity (and Area if applicable)	Description	Time From	Time To
Supply of alcohol for consumption	OFF the premises only Monday to Sunday	7:00am	9:00pm

## THE OPENING HOURS OF THE PREMISES

Description	Time From	Time To
Monday to Sunday	7:00am	9:00pm

## WHERE THE LICENCE AUTHORISES SUPPLIES OF ALCOHOL WHETHER THESE ARE ON AND / OR OFF SUPPLIES

Supply of alcohol for consumption OFF the premises only

## NAME, (REGISTERED) ADDRESS OF HOLDER OF PREMISES LICENCE

Mohammad Salih Attuf

## REGISTERED NUMBER OF HOLDER, FOR EXAMPLE COMPANY NUMBER, CHARITY NUMBER (WHERE APPLICABLE)

## NAME OF DESIGNATED PREMISES SUPERVISOR WHERE THE PREMISES LICENCE AUTHORISES THE SUPPLY OF ALCOHOL

Dairy Sleman JALAL



# Premises Licence Summary

STATE WHETHER ACCESS TO THE PREMISES BY CHILDREN IS RESTRICTED OR PROHIBITED

Not restricted other than by Statute

Signed by:



on behalf of South Holland Council



PLANS OF PREMISES

THIS DRAWING IS FOR PLANNING PURPOSES ONLY  
 ALL DIMENSIONS & DETAILS TO BE CHECKED ON SITE PRIOR TO  
 COMMENCEMENT OF WORKS ON SITE  
 THIS DRAWING IS THE COPYRIGHT OF SHEPHERD TECHNICAL SERVICES  
 THIS DRAWING IS TO BE READ IN CONJUNCTION WITH THE  
 FOLLOWING FIG. NO.

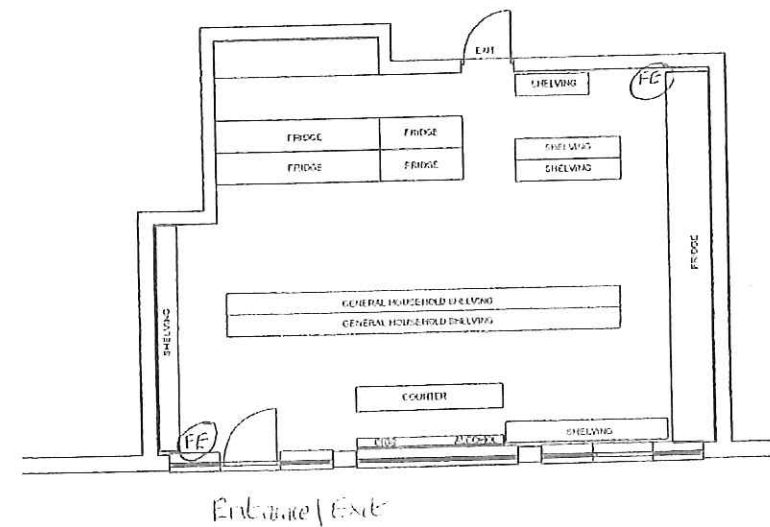

A 10/11 (P) (P) (P) (P) (P) (P)  
 Name Date Description  
 M. H. Harkin  
 LICENSING  
 M. H. Harkin  
 PLANS FOR LICENCE  
 UNIT 2 - 20 WESTFLODE ST. SPALDING  
 LINCOLNSHIRE PE11 2AF  
 Drawing title  
 Existing Plans  
 Shepherd Technical Services  
 110 Southside Road  
 Southwark  
 North London  
 SE16 5NL  
 Tel: 01753 33733  
 Fax: 01753 33724

SHEPHERD TECHNICAL SERVICES  
 Architectural, Civil & Electrical Design Consultancy  
 Date: JUNE 11  
 Drawn: JF/BAJ/AM  
 Drawn: JF  
 Drawing No: C127(A)/101 rev A

